

ACTpro 100e

Single Door Station

ACT

Access Control Technology

Product Overview

The ACTpro 100e door station facilitates the expansion of an additional door on the ACTpro 1500 / 2000 / 4000/ 4200 controllers.

Features include:

- Main Relay for door control
AUX relay for alarm monitoring
- Supports all ACTpro readers (RFID 125KHz, MIFARE Classic, DESFire EV1)
- Break Glass Monitoring (1500, 4000 only)
- Voltage Monitoring (1500, 4000 only)
- Supports Clock&Data or Wiegand readers
- Multiple entry & exit readers
- Reader short circuit protection
- Request to exit
- Door monitoring
- Tamper and Mains present monitoring
- Status LED's
- Space in enclosure for cable management
- Interlock
- Anti passback

Installation / Specification Guidelines

- For indoor use only
- The ACTpro 100e door station is compatible with the ACTpro 1500 / 2000 / 4000 / 4200 controllers
- The ACTpro 100e door station can exist on the same doors network as the ACTpro 100 / 101/ 102 / 200.



ACTpro 100e

Product Specification

Operating Voltage:	12V DC
Consumption:	40 / 120 mA
Weight:	434 grams
Operating Temperature:	-10 to +50 C
Dimensions (HxWxD):	165 x 236 x 55 mm
Mounting:	Surface
Installation:	Indoor



Use ACT Software or a Web browser to configure and manage the ACTpro 1500 controller. If there is more than one ACTpro 1500 on site use the ACT software.

Cabling Chart

From	To	Cable	Restriction
Controller or Door Station	Reader	8 core screen	Max distance: 100m at 12V DC 30m at 5V DC
ACTpro 100e	Controller	8 core shielded & twisted cable, Belden 9501 or equivalent	Doors network (RS485) maximum distance is 1.4Km, used shielded cable similar to Belden 9501

Ordering Information

ACTpro 100e Door Station	ACTpro 100e
--------------------------	-------------

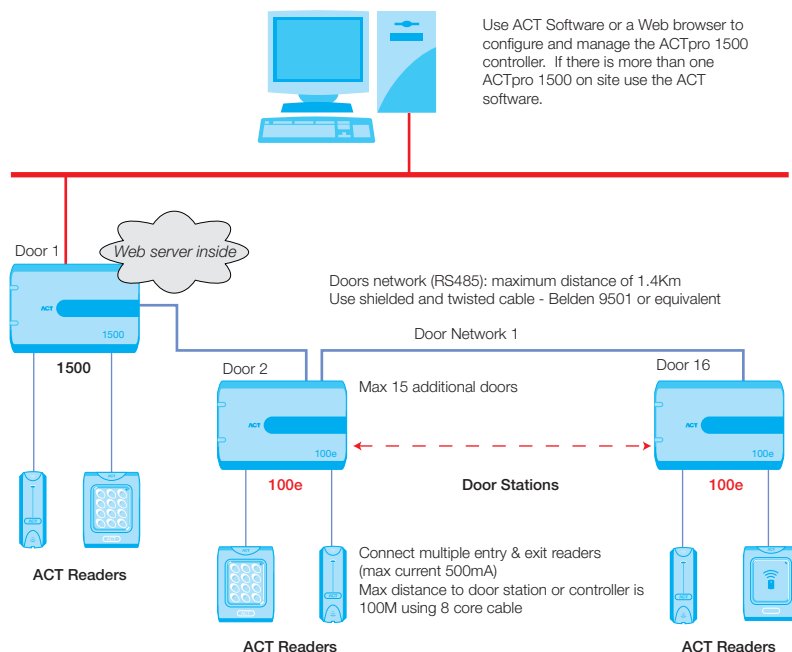

ACTpro 100e & ACTpro 1500 Schematic

Access Control Technology Unit C1, South City Business Park, Tallaght, Dublin 24, Ireland.

t: 353 (0) 1 466 2570. UK Lo-call: 0845 300 5004 f: 353 (0) 1 452 0427.

e: sales@accesscontrol.ie. w: www.accesscontrol.ie

